

Lamp Installation

- (1) Fix the lamp bracket to the lamp.
- (2) Fix the motorcycle bracket in place with the screws.
- (3) Install the lamp onto the motorcycle bracket.

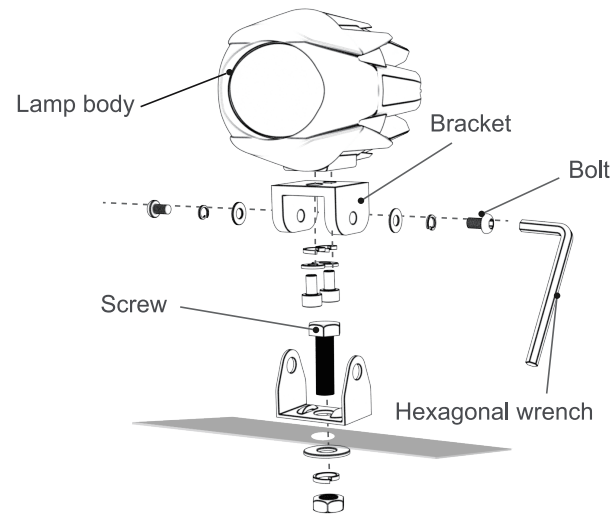

- (1) Fix the lamp bracket to the lamp.
- (2) The gasket is fixed inside the bracket.
- (3) Install the lamp onto the motorcycle bracket.

(Two screw lengths available.)

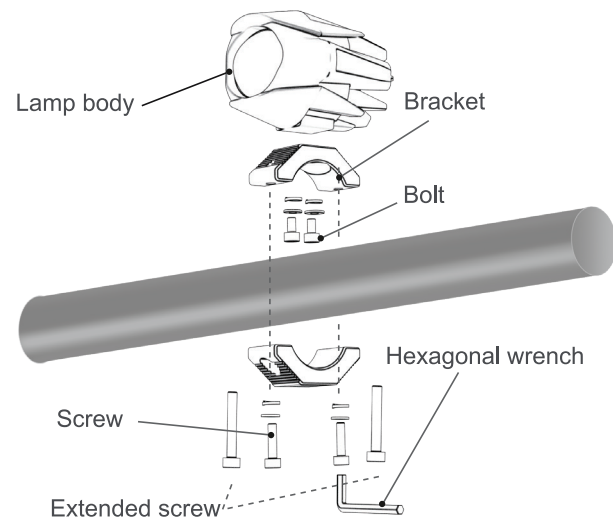
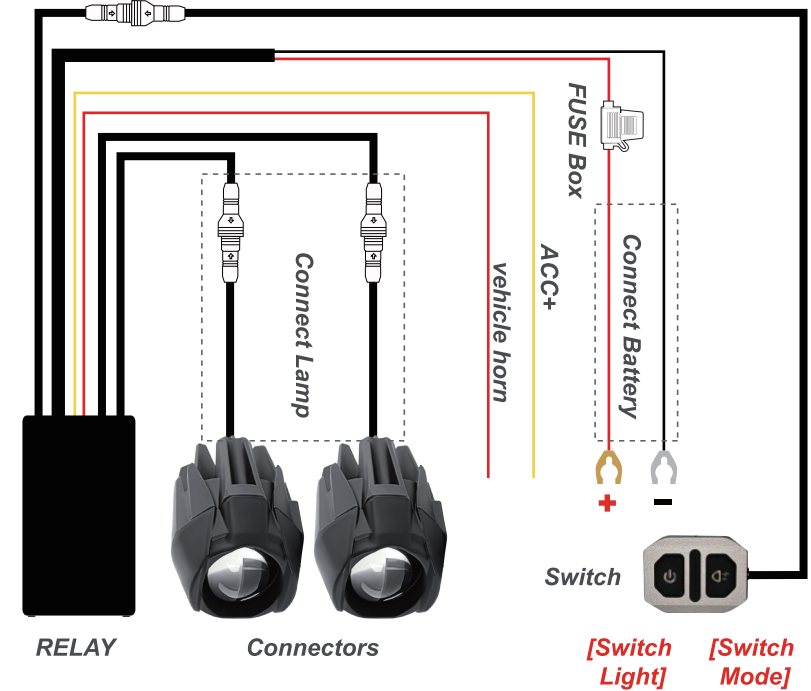

Diagram of Connection

Length: 1.8m



- (1) Access the motorcycle battery and disconnect the negative (-) and positive (+) terminals.
- (2) Connect the light ends of the harness to your lights.
- (3) Plug the ACC (Yellow) wire into the 12V positive output line (ignition Switch Positive Wire).
- (4) Connect the horn (Red) wire to the motorcycle light horn wire.
- (5) Secure the wiring harness switch to the handlebar.
- (6) Attach the (+) terminal and (-) terminal to the battery.
- (7) Secure any excess wiring with zip ties and mount your relay and controller in a secure location.



Method 1



Method 2



Method 3



High and low beam Switch
(Amber, White, Amber+White)

Strobe Mode Switch

(White/
White Strobe/
Amber/
Amber strobe)



- Press and hold any button for two seconds to turn it off



COLIGHT 3" MF Series Motorcycle Lights With Wire Harness

Warranty

- **Duration:** 2-Year Warranty from the date of purchase.
- **Coverage:** Manufacturing defects, LED failure, waterproofing issues.
- **Exclusions:** Damage from misuse, crashes, modifications, or improper installation.



Visit us on www.led-colight.com for your offroad needs.
For any additional assistance or inquiries, feel free to contact our customer support at support@led-colight.com